

ZESTAWIENIE STALI

Nr poz.	Ø	Długość przel.	Liczba		Długość przel.		Ø	Długość przel.	Ø	Długość przel.
			przeł.	pos.	przeł.	pos.				
1	10	10	1	1	1	1	1	1	1	1
2	10	10	1	1	1	1	1	1	1	1
3	10	10	1	1	1	1	1	1	1	1
4	10	10	1	1	1	1	1	1	1	1
5	10	10	1	1	1	1	1	1	1	1
6	10	10	1	1	1	1	1	1	1	1
7	10	10	1	1	1	1	1	1	1	1
8	10	10	1	1	1	1	1	1	1	1
9	10	10	1	1	1	1	1	1	1	1
10	10	10	1	1	1	1	1	1	1	1
11	10	10	1	1	1	1	1	1	1	1
12	10	10	1	1	1	1	1	1	1	1
13	10	10	1	1	1	1	1	1	1	1
14	10	10	1	1	1	1	1	1	1	1
15	10	10	1	1	1	1	1	1	1	1
16	10	10	1	1	1	1	1	1	1	1
17	10	10	1	1	1	1	1	1	1	1
18	10	10	1	1	1	1	1	1	1	1
19	10	10	1	1	1	1	1	1	1	1
20	10	10	1	1	1	1	1	1	1	1
21	10	10	1	1	1	1	1	1	1	1
22	10	10	1	1	1	1	1	1	1	1
23	10	10	1	1	1	1	1	1	1	1
24	10	10	1	1	1	1	1	1	1	1
25	10	10	1	1	1	1	1	1	1	1
26	10	10	1	1	1	1	1	1	1	1
27	10	10	1	1	1	1	1	1	1	1
28	10	10	1	1	1	1	1	1	1	1
29	10	10	1	1	1	1	1	1	1	1
30	10	10	1	1	1	1	1	1	1	1
31	10	10	1	1	1	1	1	1	1	1
32	10	10	1	1	1	1	1	1	1	1
33	10	10	1	1	1	1	1	1	1	1
34	10	10	1	1	1	1	1	1	1	1
35	10	10	1	1	1	1	1	1	1	1
36	10	10	1	1	1	1	1	1	1	1
37	10	10	1	1	1	1	1	1	1	1
38	10	10	1	1	1	1	1	1	1	1
39	10	10	1	1	1	1	1	1	1	1
40	10	10	1	1	1	1	1	1	1	1
41	10	10	1	1	1	1	1	1	1	1
42	10	10	1	1	1	1	1	1	1	1
43	10	10	1	1	1	1	1	1	1	1
44	10	10	1	1	1	1	1	1	1	1
45	10	10	1	1	1	1	1	1	1	1
46	10	10	1	1	1	1	1	1	1	1
47	10	10	1	1	1	1	1	1	1	1
48	10	10	1	1	1	1	1	1	1	1
49	10	10	1	1	1	1	1	1	1	1
50	10	10	1	1	1	1	1	1	1	1
51	10	10	1	1	1	1	1	1	1	1
52	10	10	1	1	1	1	1	1	1	1
53	10	10	1	1	1	1	1	1	1	1
54	10	10	1	1	1	1	1	1	1	1
55	10	10	1	1	1	1	1	1	1	1
56	10	10	1	1	1	1	1	1	1	1
57	10	10	1	1	1	1	1	1	1	1
58	10	10	1	1	1	1	1	1	1	1
59	10	10	1	1	1	1	1	1	1	1
60	10	10	1	1	1	1	1	1	1	1
61	10	10	1	1	1	1	1	1	1	1
62	10	10	1	1	1	1	1	1	1	1
63	10	10	1	1	1	1	1	1	1	1
64	10	10	1	1	1	1	1	1	1	1
65	10	10	1	1	1	1	1	1	1	1
66	10	10	1	1	1	1	1	1	1	1
67	10	10	1	1	1	1	1	1	1	1
68	10	10	1	1	1	1	1	1	1	1
69	10	10	1	1	1	1	1	1	1	1
70	10	10	1	1	1	1	1	1	1	1
71	10	10	1	1	1	1	1	1	1	1
72	10	10	1	1	1	1	1	1	1	1
73	10	10	1	1	1	1	1	1	1	1
74	10	10	1	1	1	1	1	1	1	1
75	10	10	1	1	1	1	1	1	1	1
76	10	10	1	1	1	1	1	1	1	1
77	10	10	1	1	1	1	1	1	1	1
78	10	10	1	1	1	1	1	1	1	1
79	10	10	1	1	1	1	1	1	1	1
80	10	10	1	1	1	1	1	1	1	1
81	10	10	1	1	1	1	1	1	1	1
82	10	10	1	1	1	1	1	1	1	1
83	10	10	1	1	1	1	1	1	1	1
84	10	10	1	1	1	1	1	1	1	1
85	10	10	1	1	1	1	1	1	1	1
86	10	10	1	1	1	1	1	1	1	1
87	10	10	1	1	1	1	1	1	1	1
88	10	10	1	1	1	1	1	1	1	1
89	10	10	1	1	1	1	1	1	1	1
90	10	10	1	1	1	1	1	1	1	1
91	10	10	1	1	1	1	1	1	1	1
92	10	10	1	1	1	1	1	1	1	1
93	10	10	1	1	1	1	1	1	1	1
94	10	10	1	1	1	1	1	1	1	1
95	10	10	1	1	1	1	1	1	1	1
96	10	10	1	1	1	1	1	1	1	1
97	10	10	1	1	1	1	1	1	1	1
98	10	10	1	1	1	1	1	1	1	1
99	10	10	1	1	1	1	1	1	1	1
100	10	10	1	1	1	1	1	1	1	1

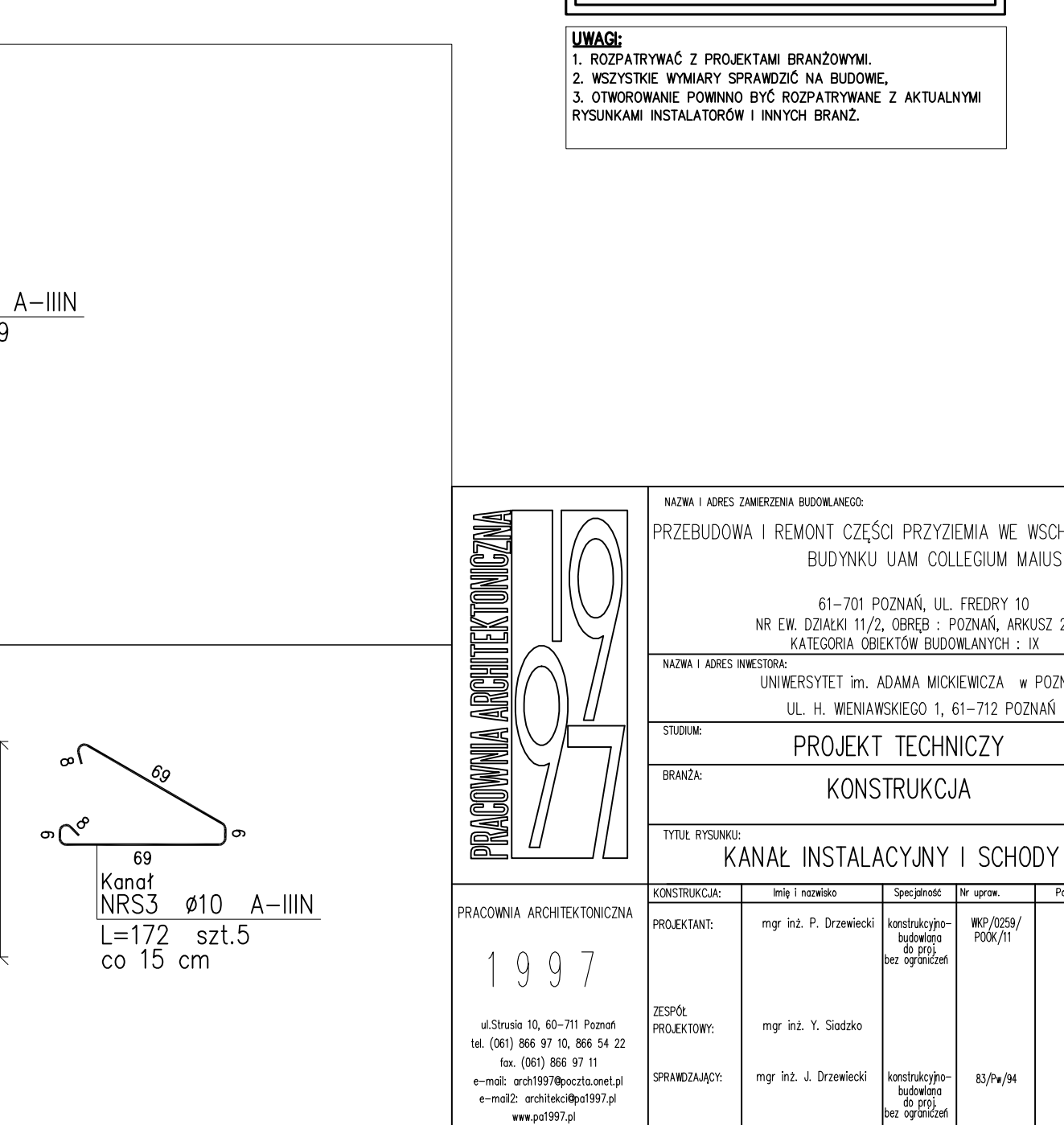
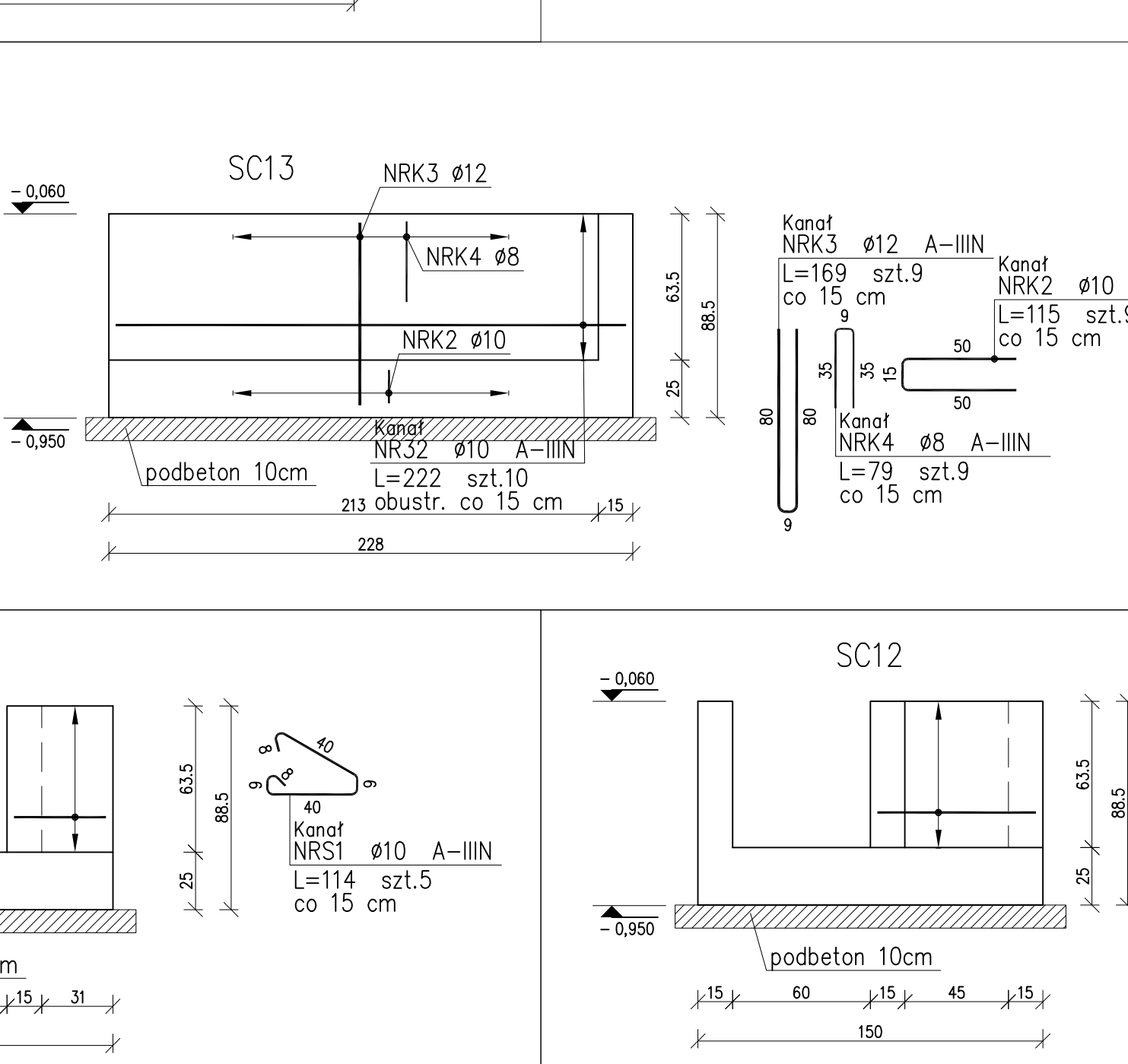
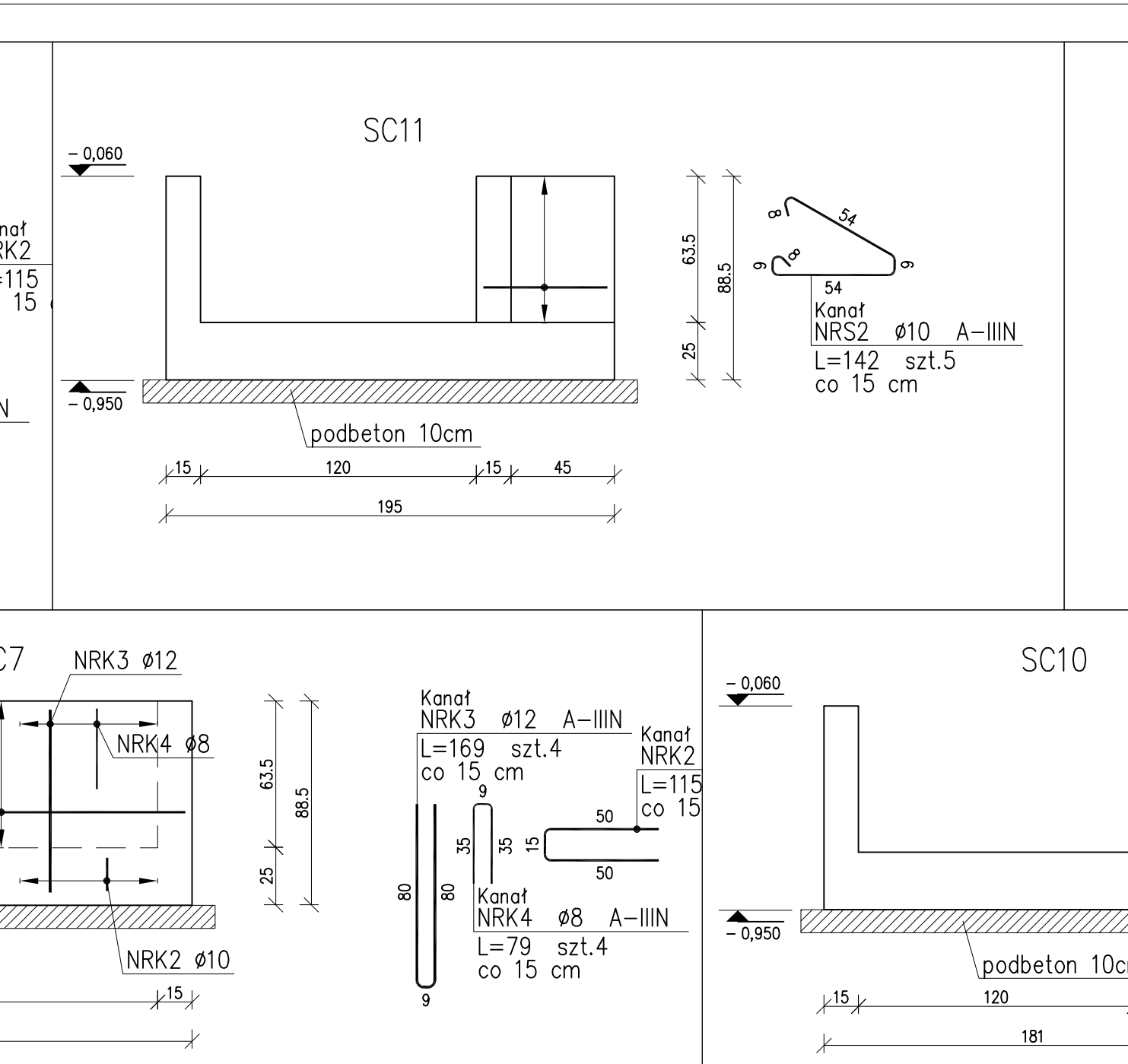
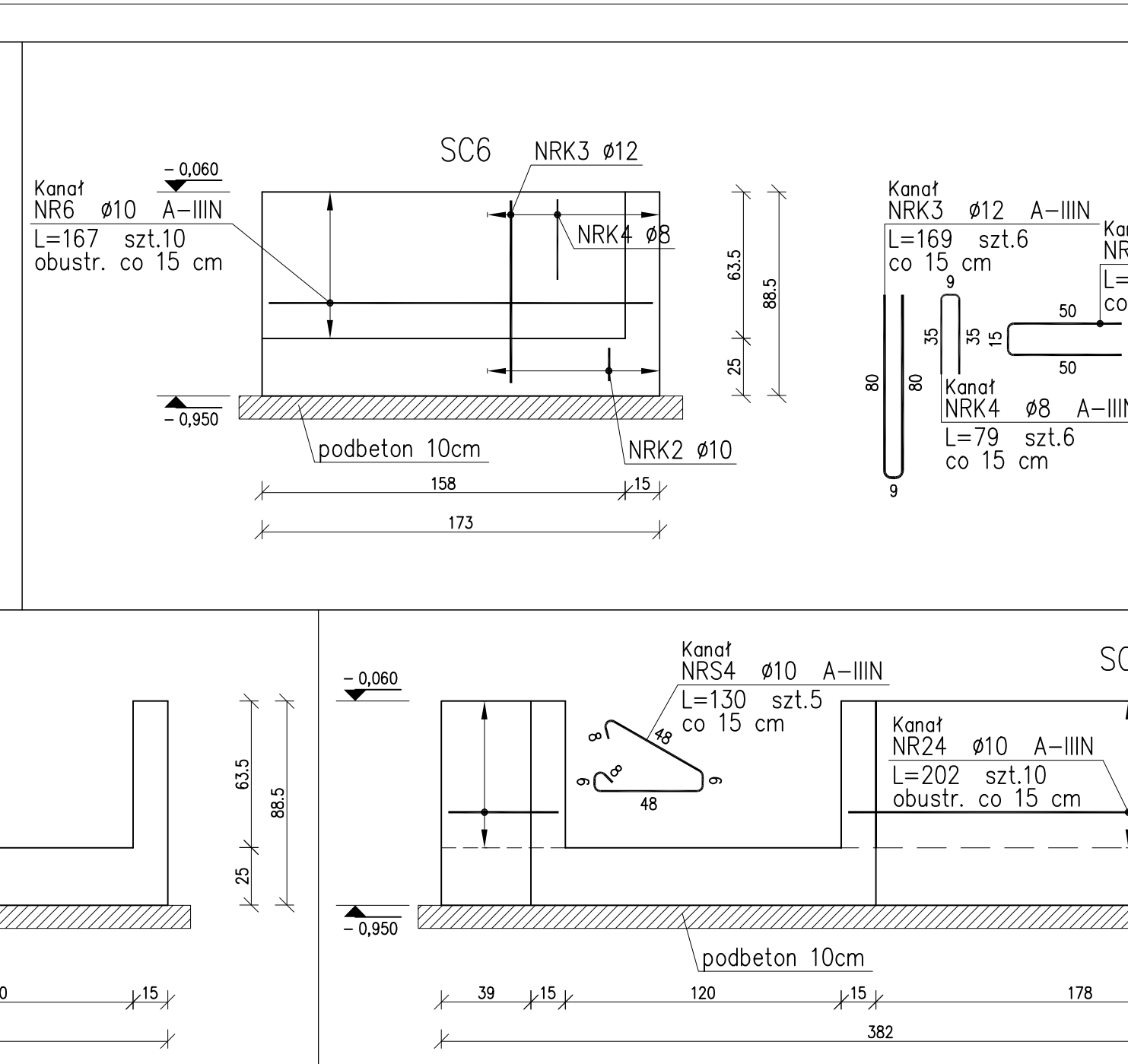
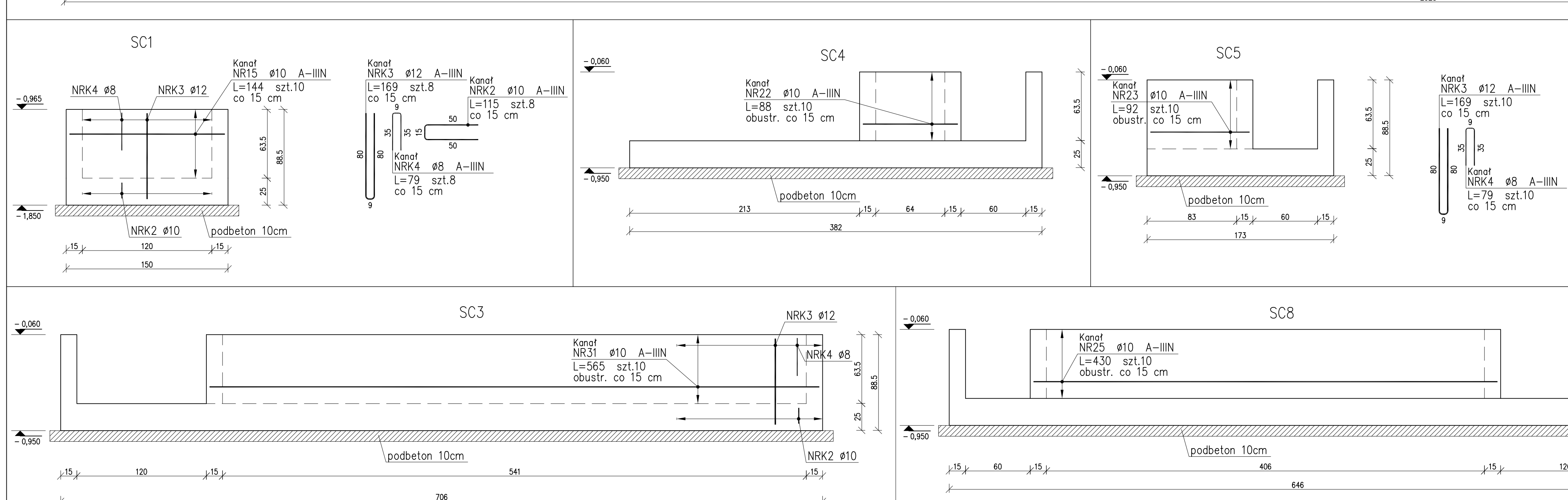
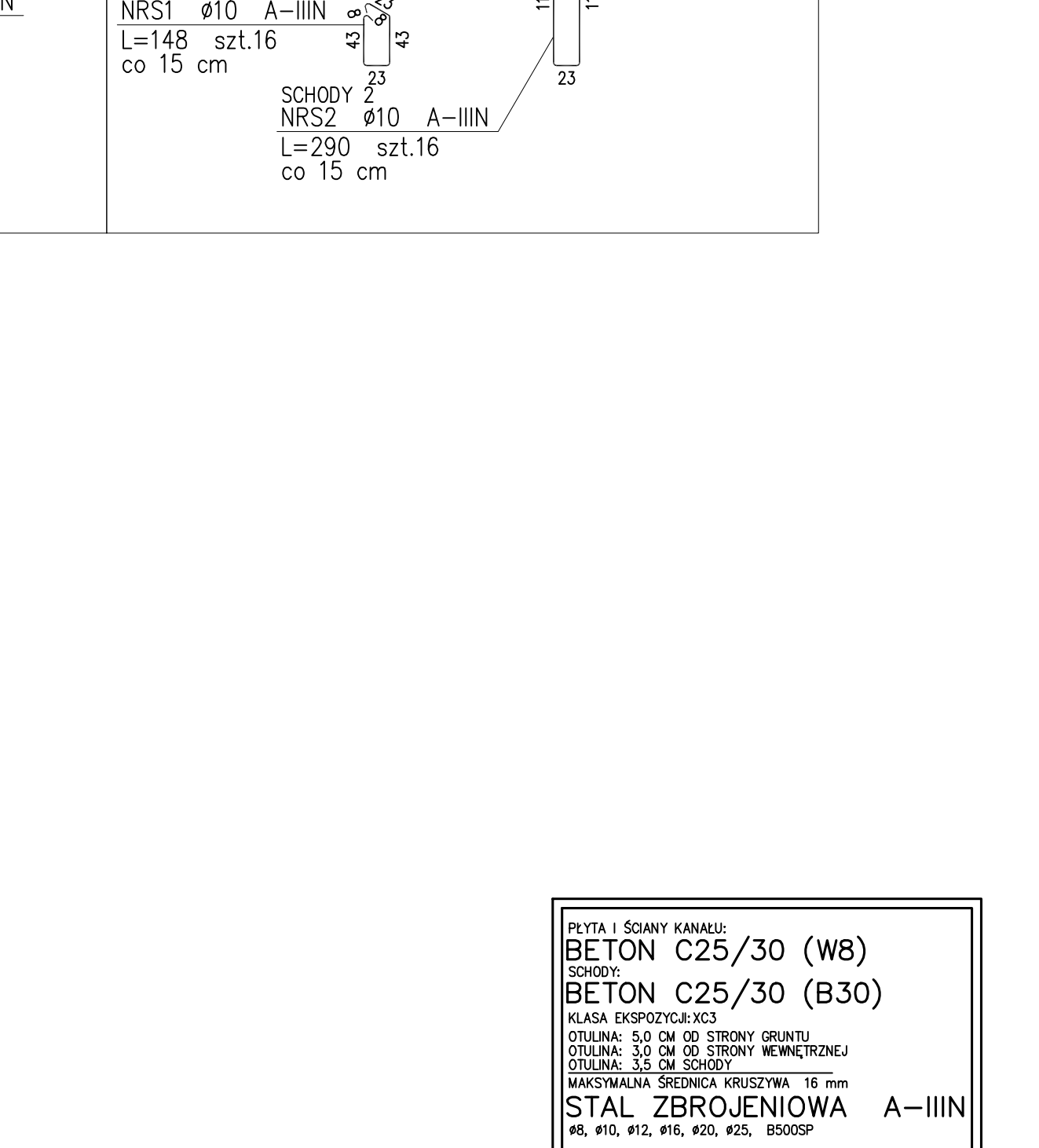
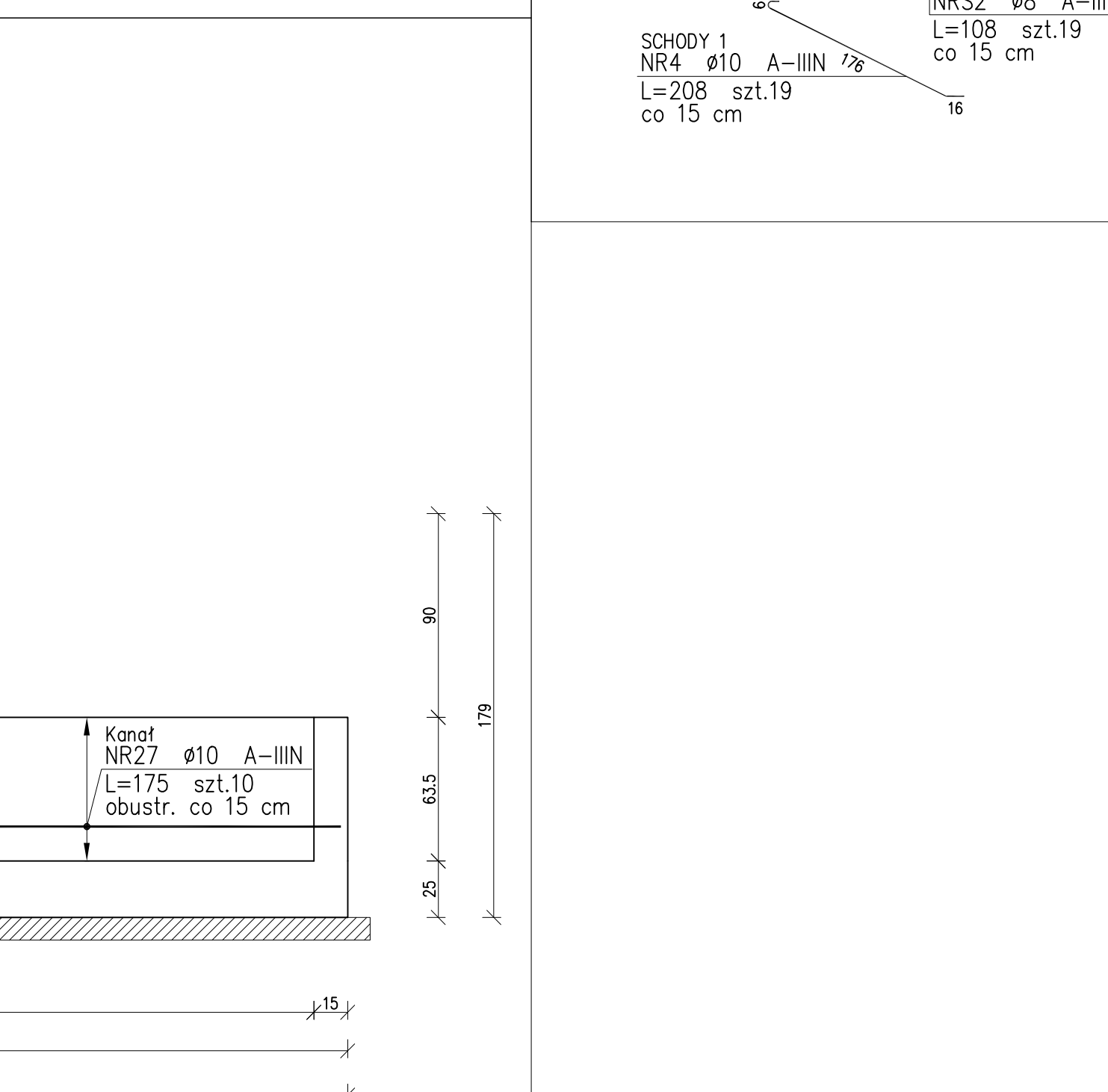
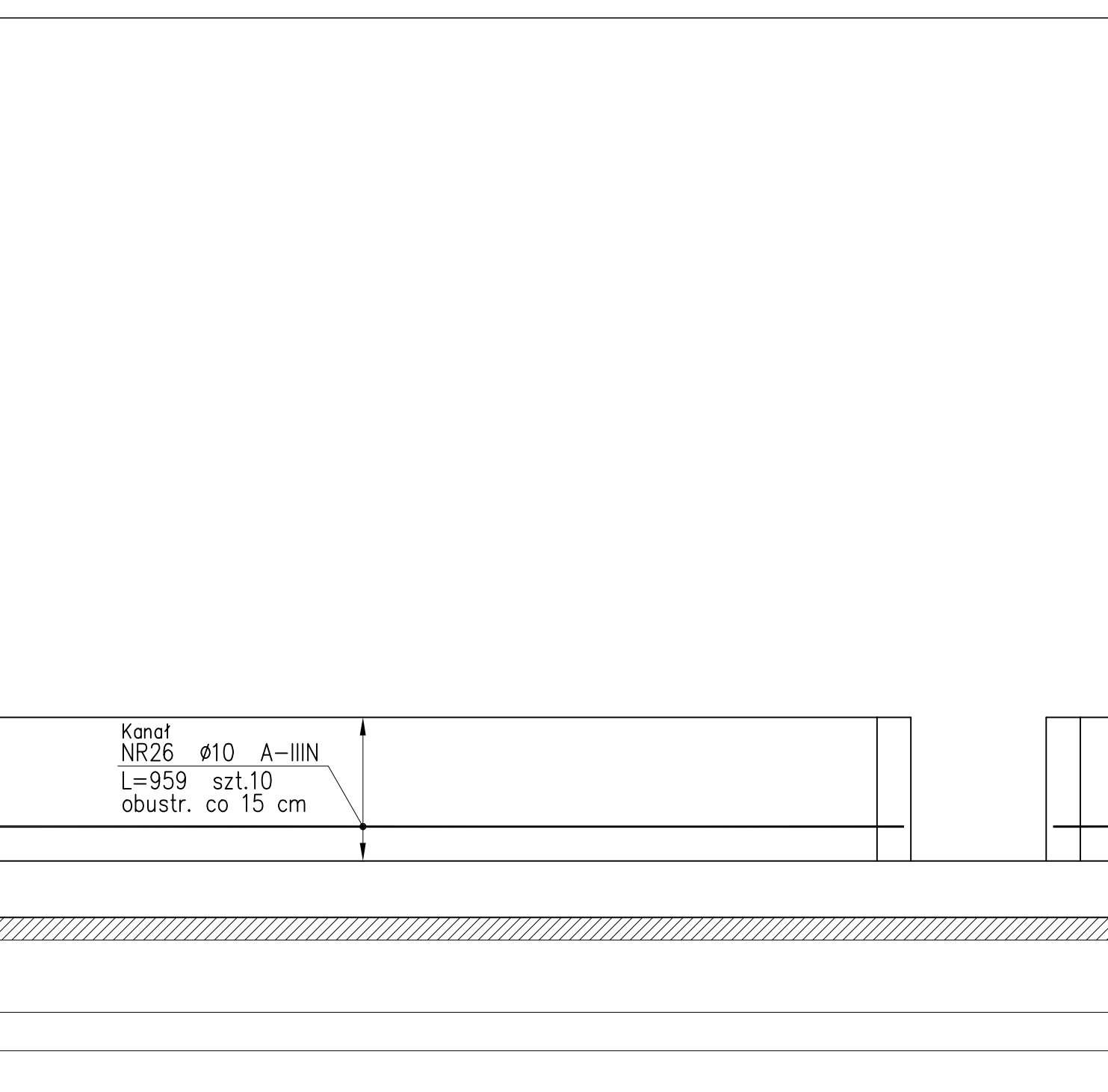
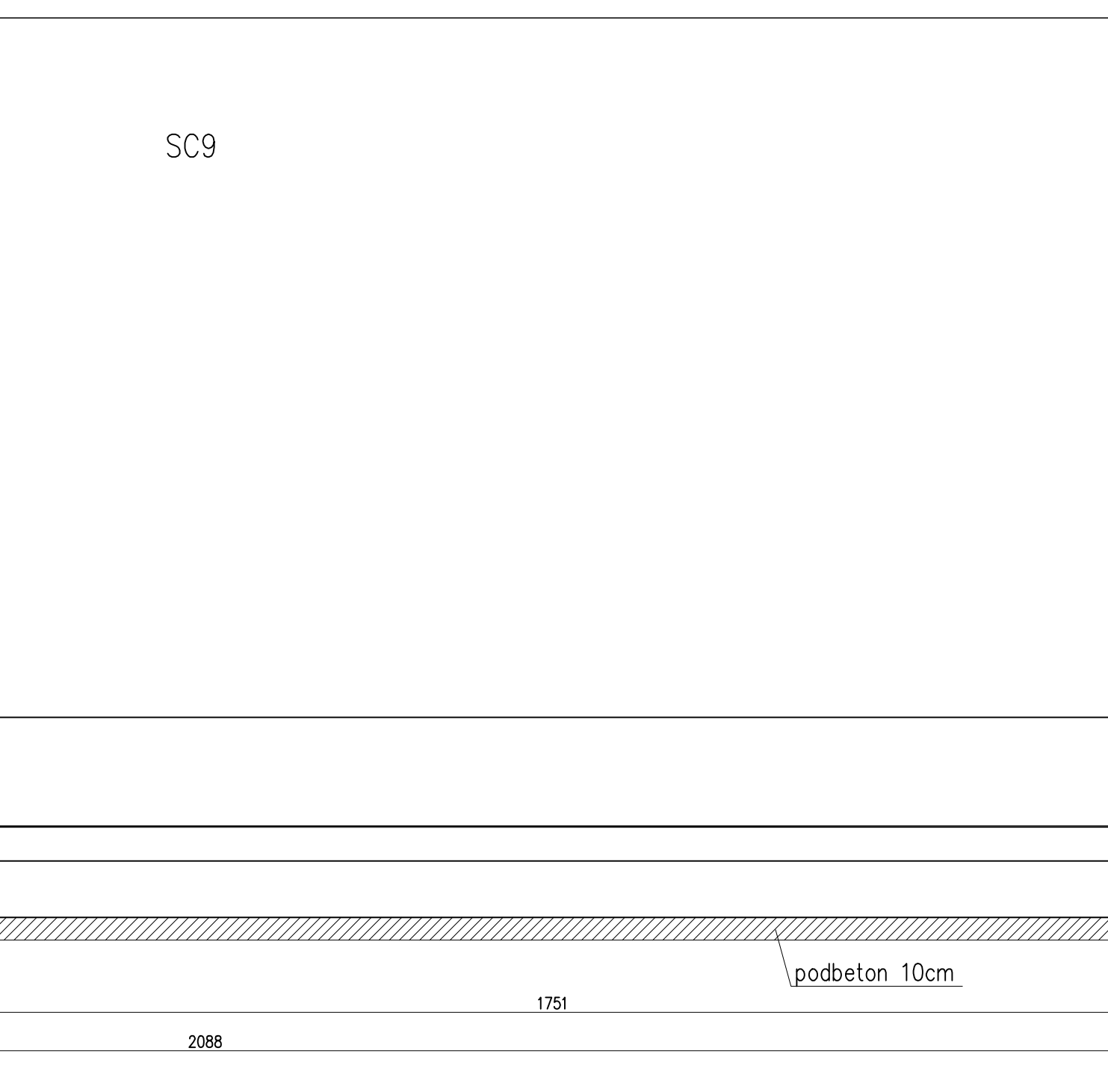
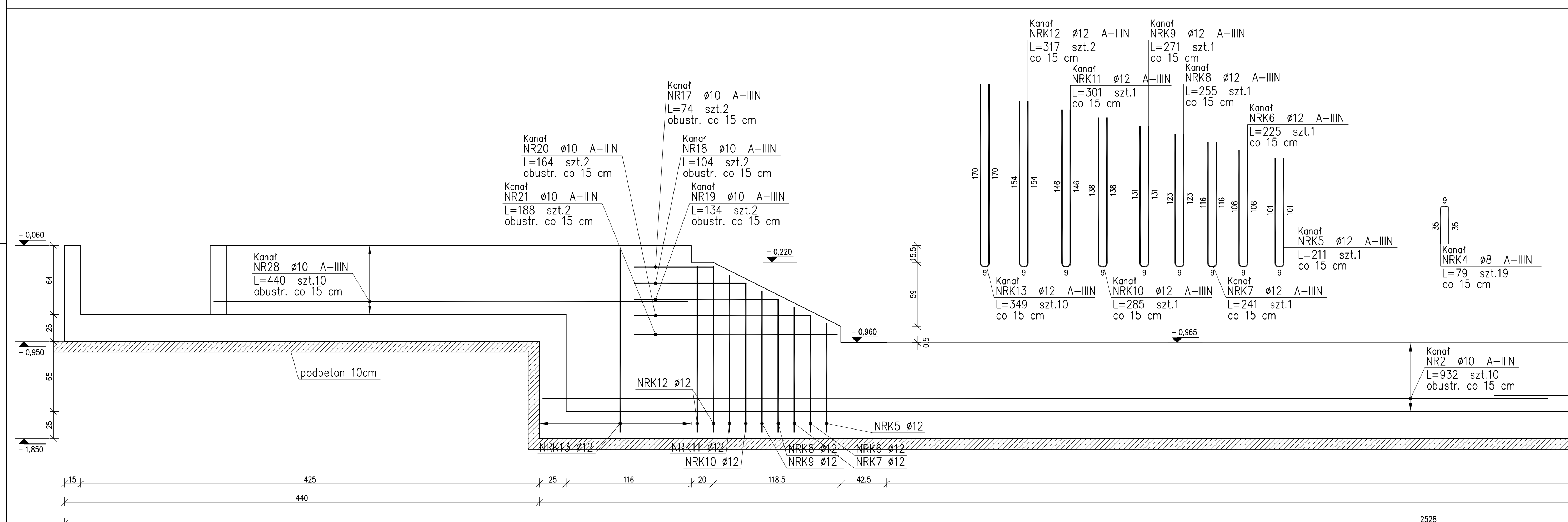
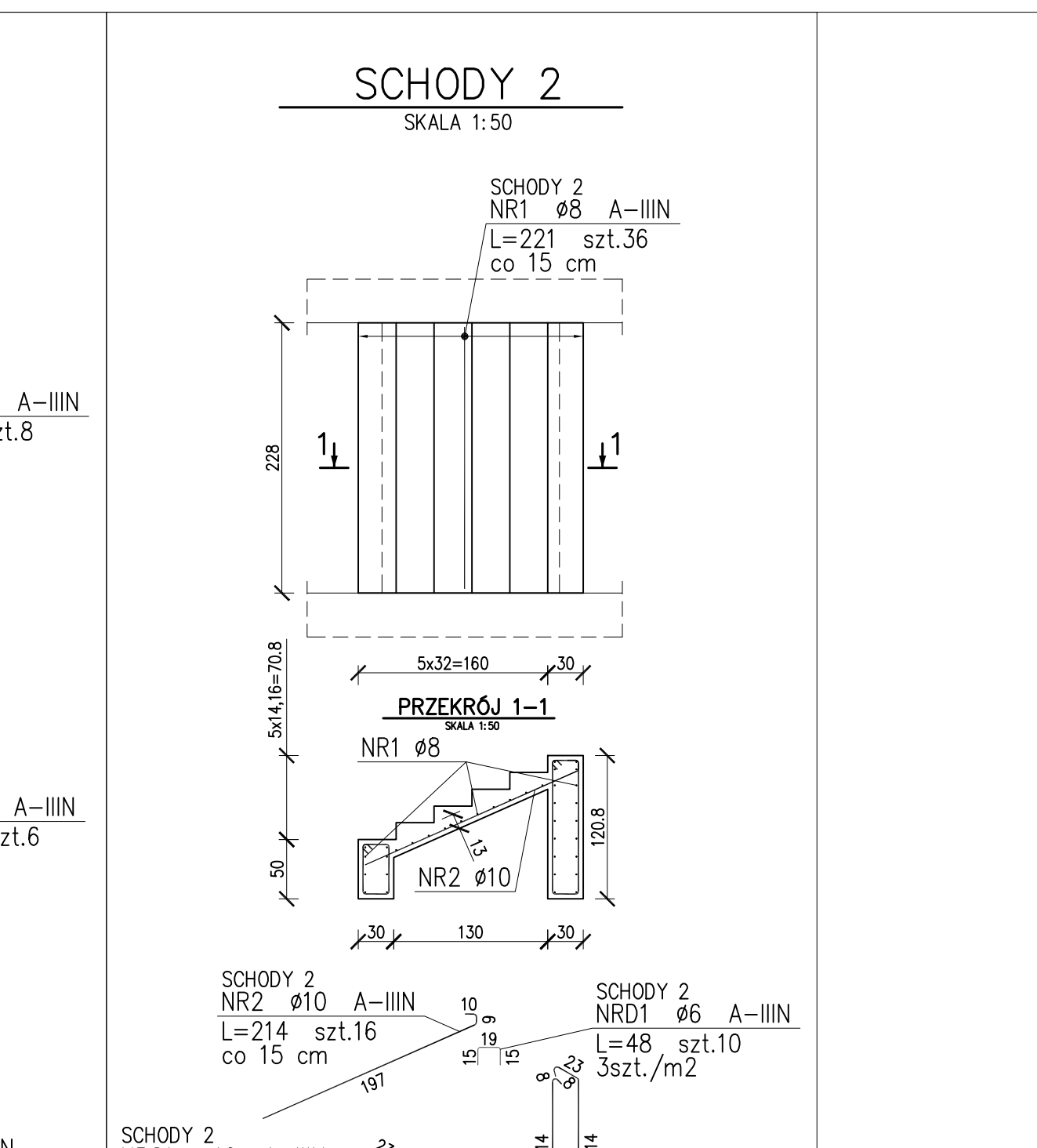
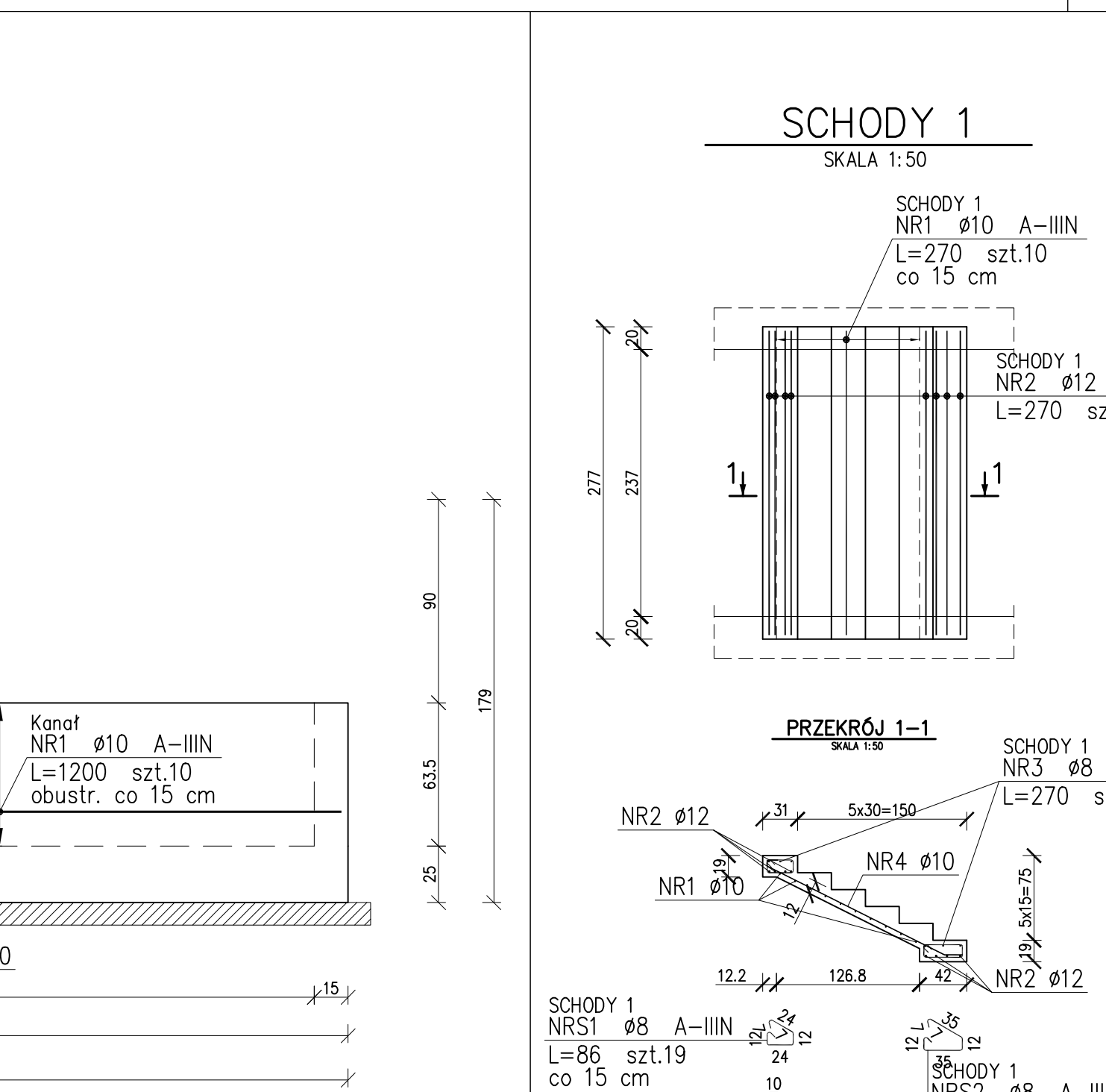
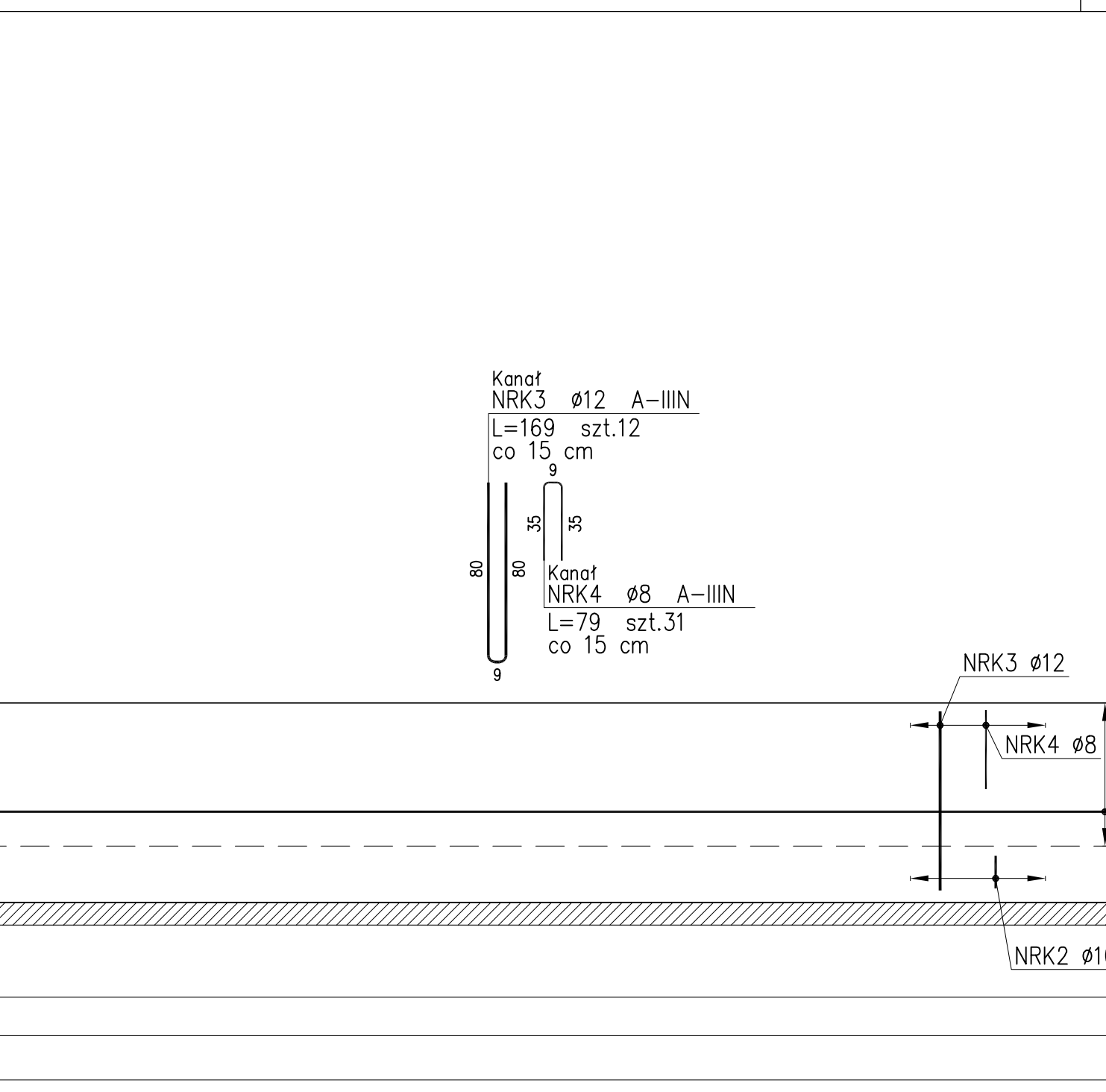
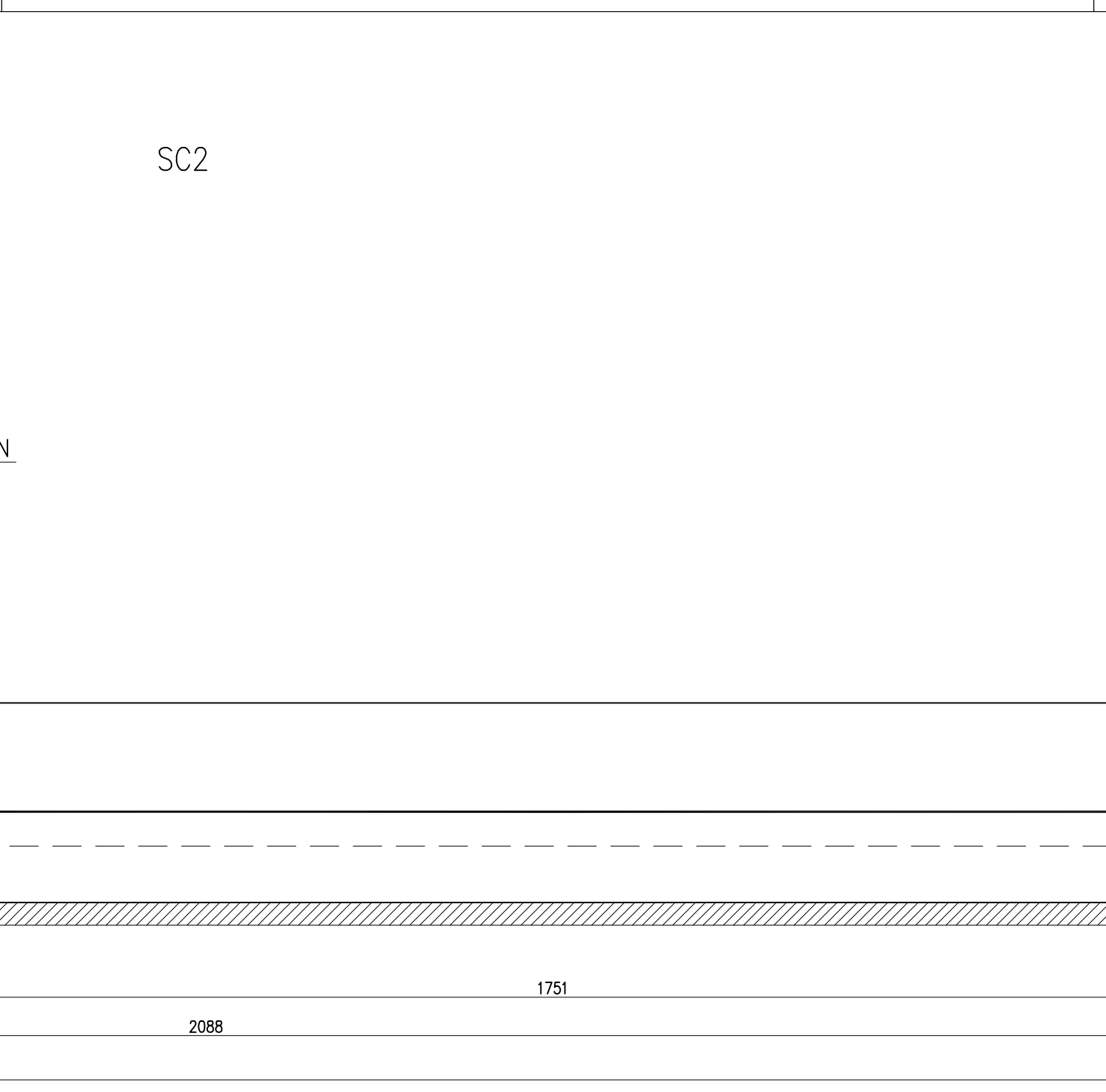
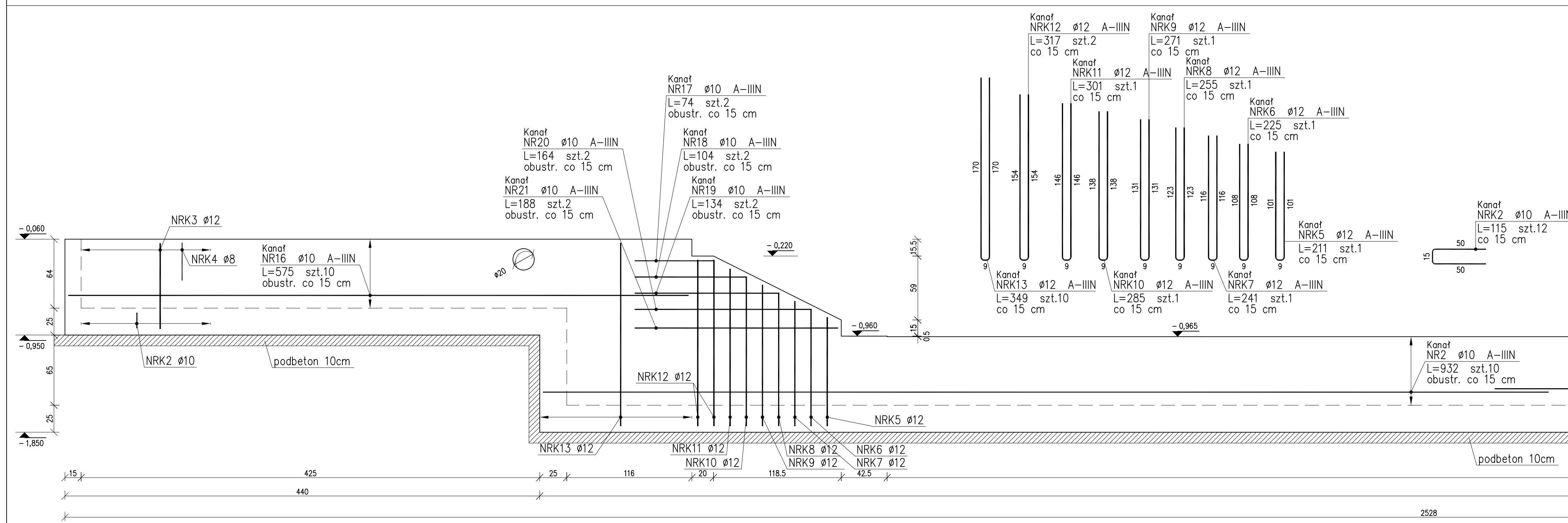

WYKONANIE PRAC
BETON C25/30 (W8)
BETON C25/30 (B30)
STAL ZBROJENIOWA A-IIIIN

PROJEKT TECHNICZNY
KONSTRUKCJA
1997